

IN-LINE CENTRIFUGAL ELECTRIC PUMPS

in AISI 304 stainless steel



In-line centrifugal electric pumps with AISI 304 stainless steel hydraulic equipment

APPLICATIONS

- Civil and industrial heating systems
- Domestic hot water handling
- Cooling and air conditioning systems
- Low pressure fluid handling in general

TECHNICAL FEATURES

- Versatile
- Silent running
- Reliable

PUMP TECHNICAL DATA

- Maximum suction pressure:
 - 2 bar for all single-phase models and LPS 25 three phase models,
 - 4 bar for LPS 32-40-50 three phase models
- Fluid temperature: -10°C - +100°C
- Flanges: DN 25 to DN 50
- MEI > 0.4 except for LPS 32/40, LPS 40/40, LPS 40/75, LPS 50/40, LPS 50/75, LPS 50/150

For further information, refer to our Data Book on www.ebaraurope.com

MOTOR TECHNICAL DATA

- IE3 high energy-efficiency motors starting from 0.75kW
- 2 poles self-ventilating asynchronous motors
- Insulation class F
- Protection rating IP55
- Single phase voltage 230V ±10% 50Hz, three phase voltage 230/400V ±10%, 50Hz
- Permanently active condenser and integrated automatic re-arming thermal cutout for the single-phase motor
- Protection must be supplied by the user for the three phase version

MATERIALS

- Pump body, impeller and gasket disk in AISI 304 stainless steel
- Shaft made of AISI 303 steel (part in contact with liquid)
- Motor mount and casing in aluminium
- Mechanical seal made of Ceramic/Carbon/NBR
- Elastomers in NBR

ACCESSORIES (on request)

- Counterflanges available in the following materials:
 - galvanised
 - AISI 304

PERFORMANCE RANGE (per ISO 9906 Annex A)

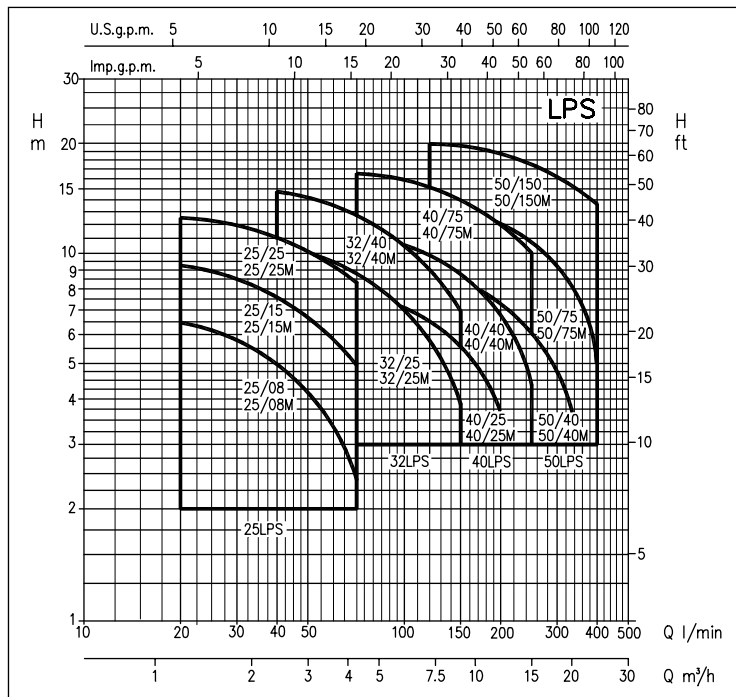

N.B. Some models not available in the EU

IDENTIFICATION CODE

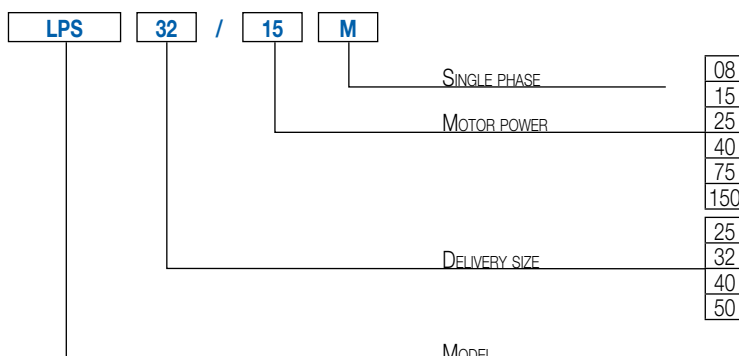



LPS

IN-LINE CENTRIFUGAL ELECTRIC PUMPS

in AISI 304 stainless steel

PERFORMANCE CURVES series LPS 25/08

(per ISO 9906 Annex A)

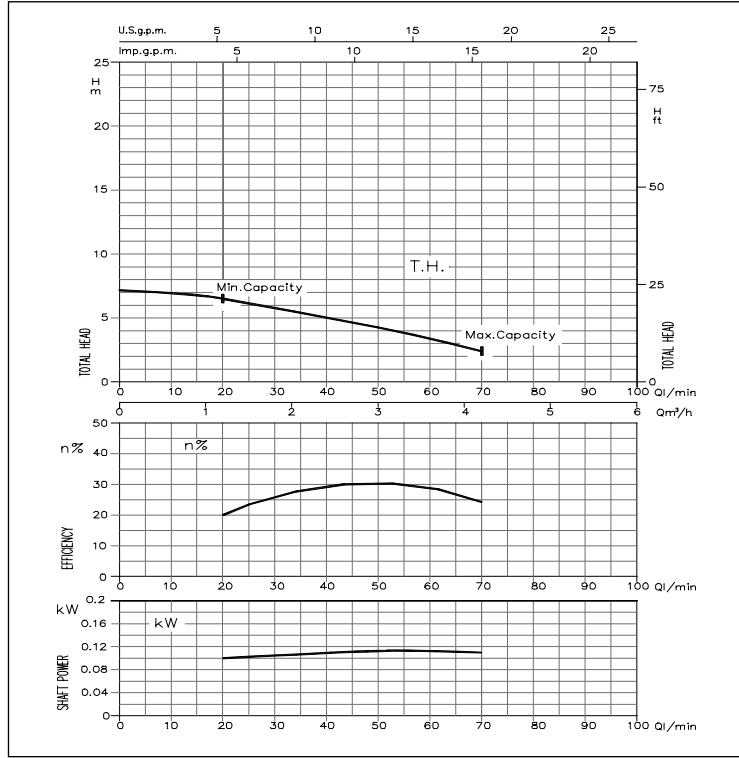

PERFORMANCE CURVES series LPS 25/15

(per ISO 9906 Annex A)

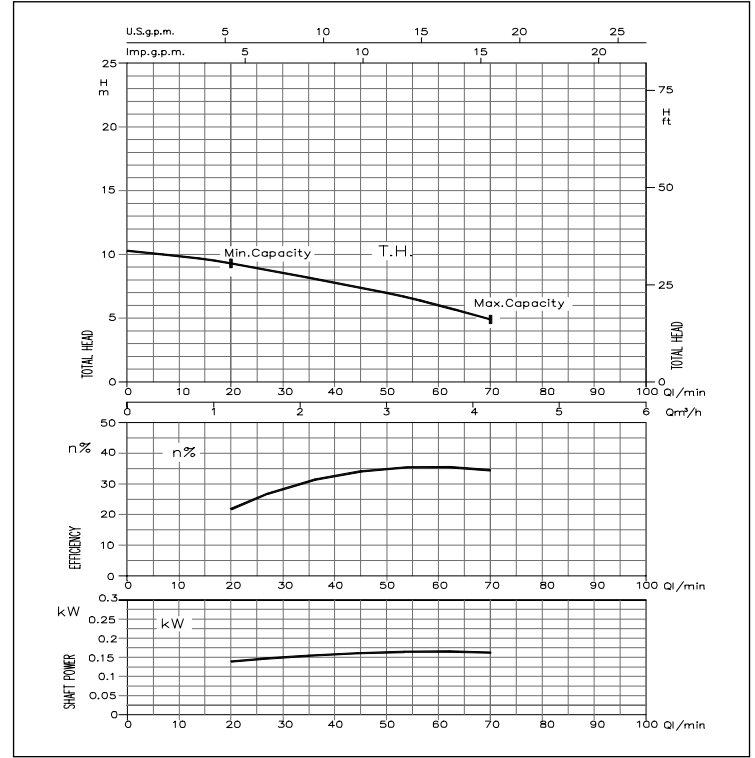

PERFORMANCE CURVES series LPS 25/25

(per ISO 9906 Annex A)

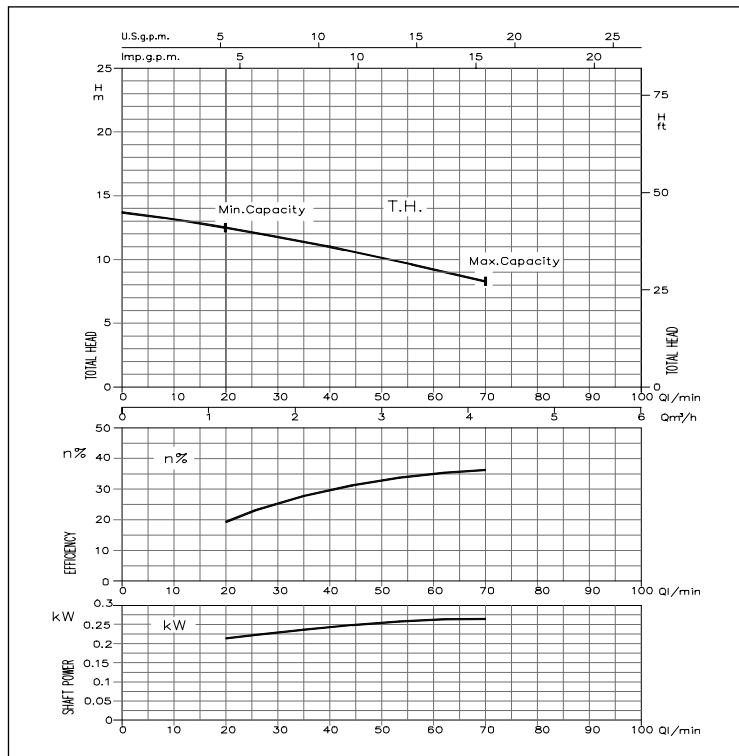

The contents of this publication should not be regarded as binding. EBARA Pumps Europe S.p.A. reserves the right to effect any modification it deems necessary, without prior notice.



LPS

IN-LINE CENTRIFUGAL ELECTRIC PUMPS

in AISI 304 stainless steel

PERFORMANCE CURVES series LPS 32/25

(per ISO 9906 Annex A)

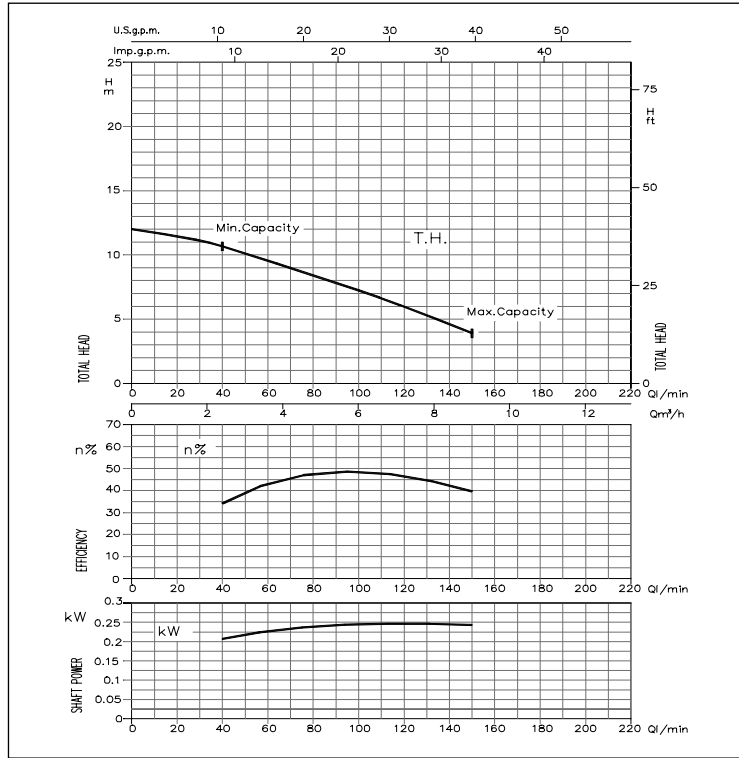

PERFORMANCE CURVES series LPS 32/40

(per ISO 9906 Annex A)

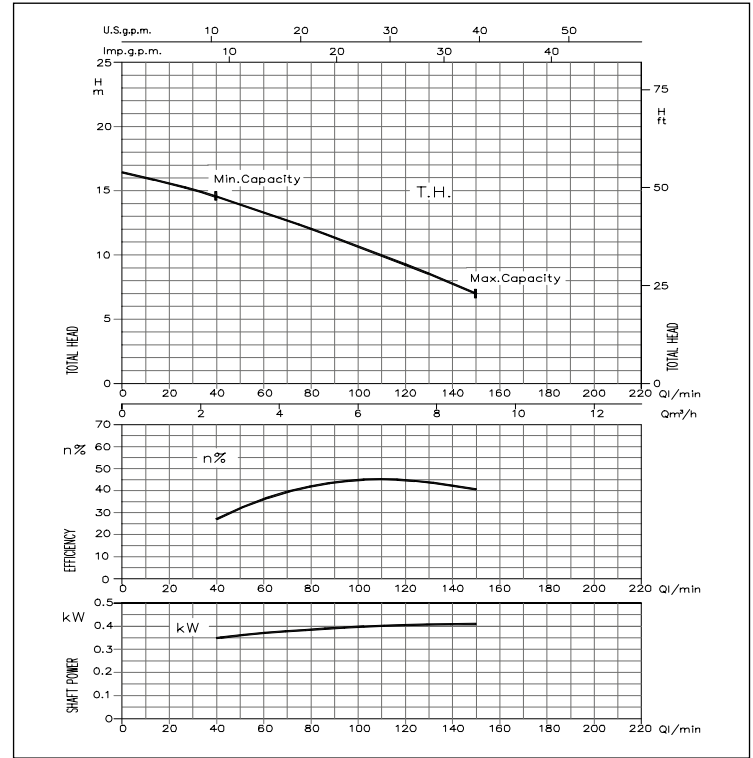

N.B. Models marked with * not available in the EU

PERFORMANCE CURVES series LPS 40/25

(per ISO 9906 Annex A)

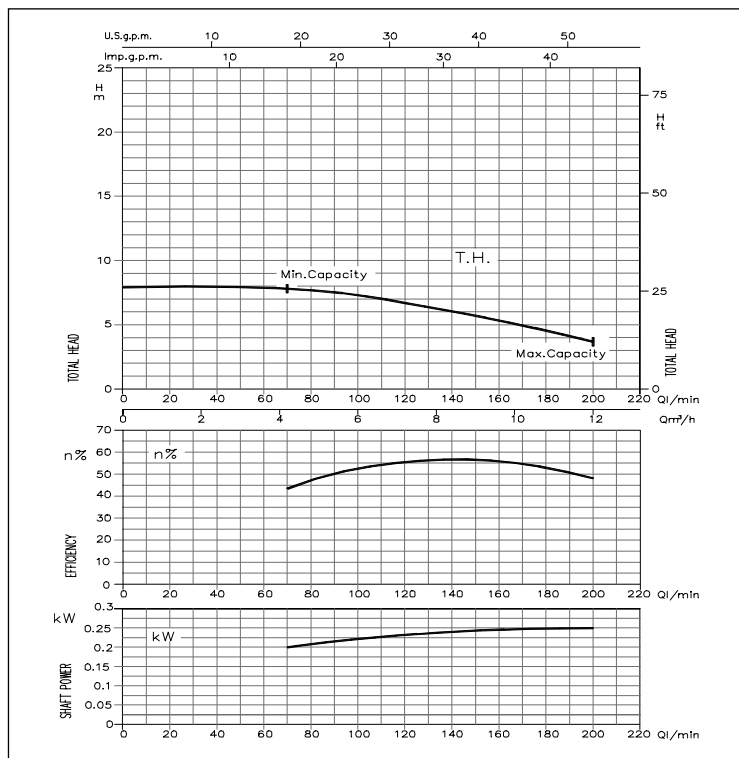

PERFORMANCE CURVES series LPS 40/40

(per ISO 9906 Annex A)

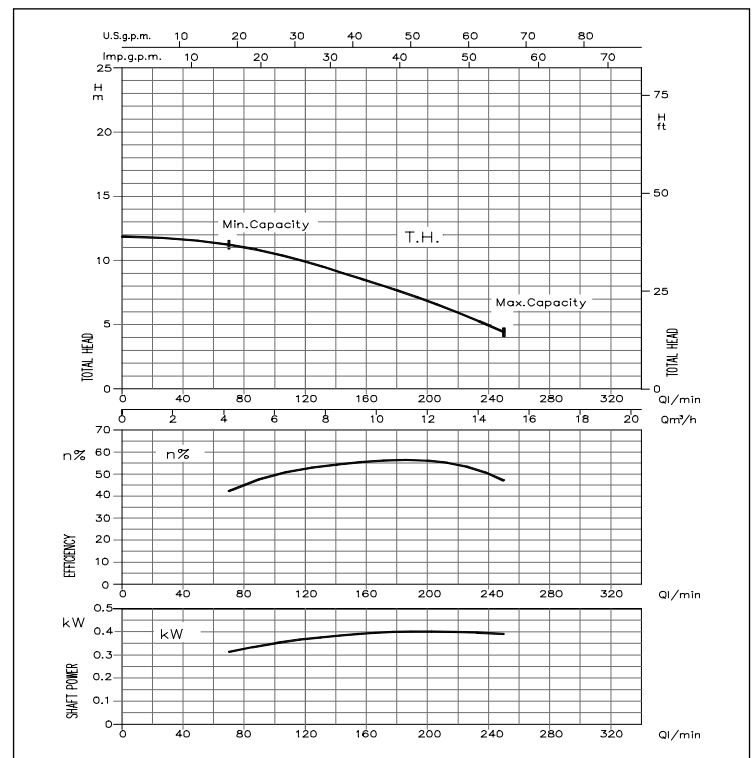

N.B. Models marked with * not available in the EU



LPS

IN-LINE CENTRIFUGAL ELECTRIC PUMPS

in AISI 304 stainless steel

PERFORMANCE CURVES series LPS 40/75

(per ISO 9906 Annex A)

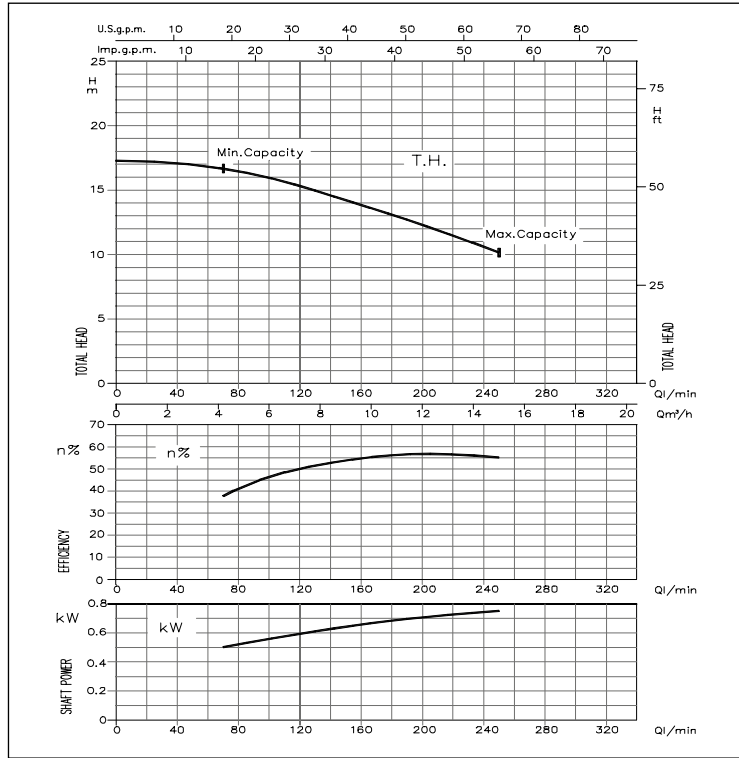

N.B. Models marked with * not available in the EU

PERFORMANCE CURVES series LPS 50/40

(per ISO 9906 Annex A)

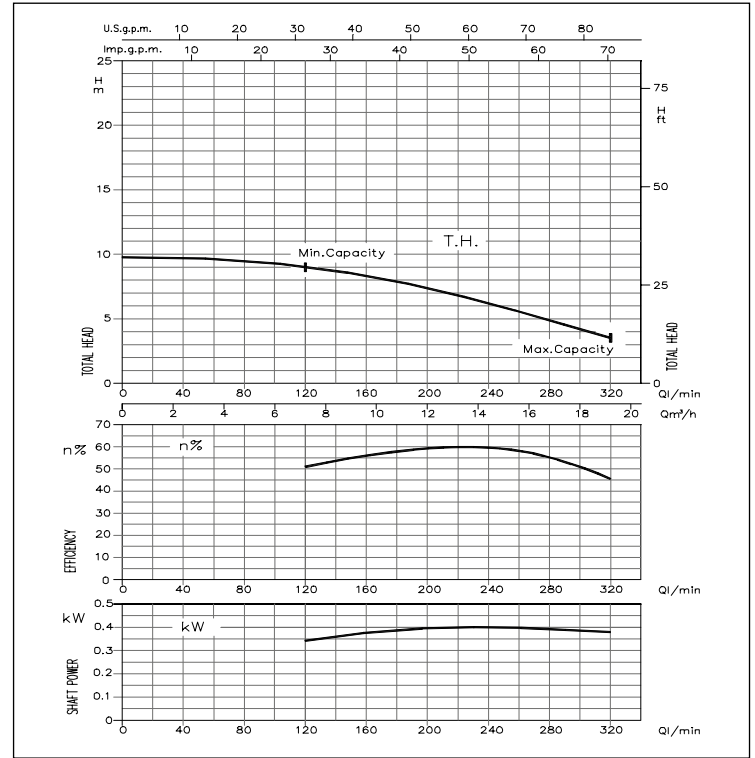

N.B. Models marked with * not available in the EU

PERFORMANCE CURVES series LPS 50/75

(per ISO 9906 Annex A)

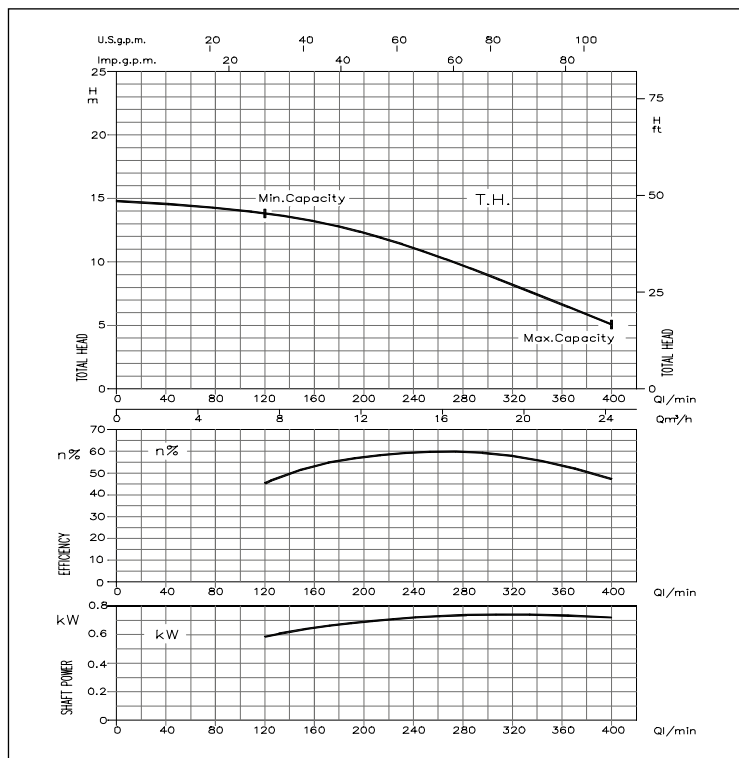

N.B. Models marked with * not available in the EU

PERFORMANCE CURVES series LPS 50/150

(per ISO 9906 Annex A)

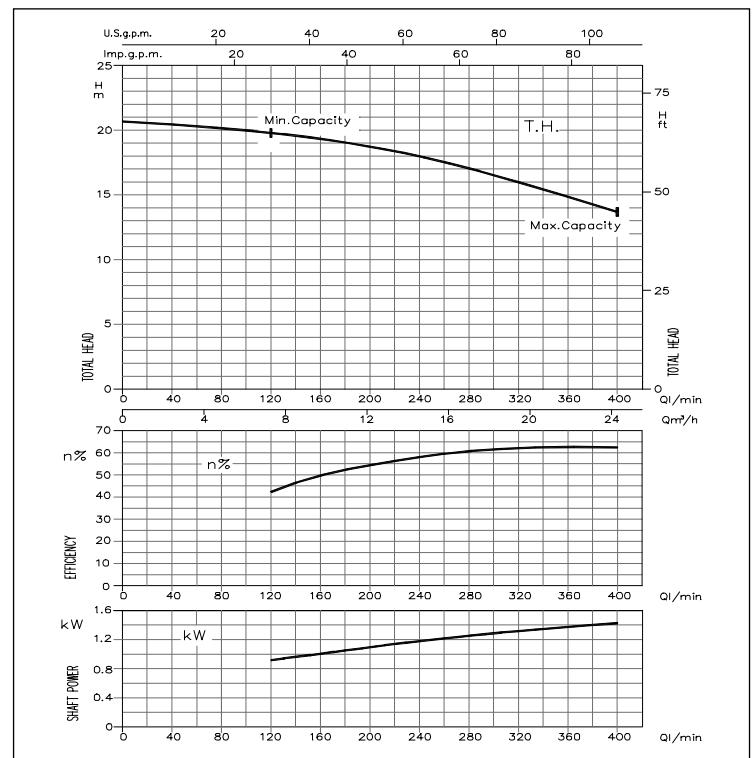

N.B. Models marked with * not available in the EU

The contents of this publication should not be regarded as binding. EBARA Pumps Europe S.p.A. reserves the right to effect any modification it deems necessary, without prior notice.

LPS

IN-LINE CENTRIFUGAL ELECTRIC PUMPS

in AISI 304 stainless steel

PERFORMANCE TABLE

Model		P ₂		Q=Flow rate										
Single phase 230V	Three phase 230/400V	[HP]	[KW]	l/min	20	40	70	100	120	150	200	250	320	400
				m ³ /h	1.2	2.4	4.2	6	7.2	9	12	15	19.2	24
					H=Head [m]									
LPS 25/08M	LPS 25/08	0.1	0.08	6.5	5.0	2.4	-	-	-	-	-	-	-	-
LPS 25/15M	LPS 25/15	0.2	0.15	9.3	7.8	4.9	-	-	-	-	-	-	-	-
LPS 25/25M	LPS 25/25	0.33	0.25	12.5	11.1	8.4	-	-	-	-	-	-	-	-
LPS 32/25M	LPS 32/25	0.33	0.25	-	10.7	9.1	7.2	5.9	3.9	-	-	-	-	-
LPS 32/40M *	LPS 32/40 *	0.5	0.4	-	14.5	12.7	10.6	9.2	7.0	-	-	-	-	-
LPS 40/25M	LPS 40/25	0.33	0.25	-	-	7.8	7.1	6.6	5.6	3.7	-	-	-	-
LPS 40/40M *	LPS 40/40 *	0.5	0.4	-	-	11.3	10.4	9.9	8.7	6.9	4.4	-	-	-
LPS 40/75M *	LPS 40/75 *	1	0.75	-	-	16.6	16.0	15.2	14.1	12.3	10.1	-	-	-
LPS 50/40M *	LPS 50/40 *	0.5	0.4	-	-	-	-	9.1	8.8	7.4	5.9	3.5	-	-
LPS 50/75M *	LPS 50/75 *	1	0.75	-	-	-	-	13.8	13.3	12.3	10.7	8.2	5.0	-
LPS 50/150M *	LPS 50/150 *	2	1.5	-	-	-	-	19.8	19.3	18.7	17.8	16.0	13.7	-

* Models not available in the EU

DIMENSIONS LPS

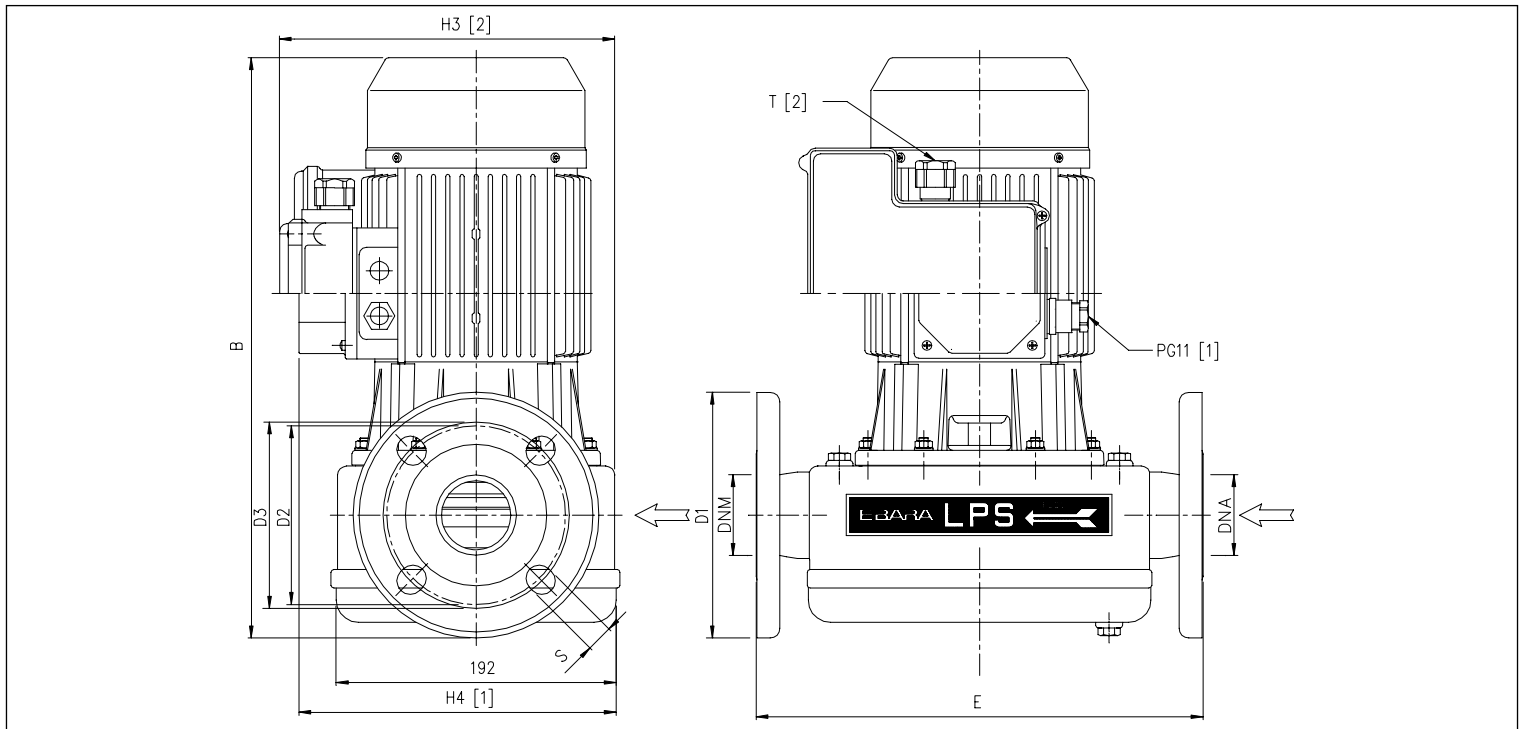

DIMENSIONS CHART

Model		Dimensions [mm]															Weight [kg]							
Single phase	Three phase	E	[2]	B	[1]	*	H3	[2]	H4	[1]	T	[2]	[1]	V	*	DNA	DNM	D1	D2	D3	S	[2]	[1]	*
LPS 25/08M	LPS 25/08	300	322	322	-	206	197.5	PG11	PG11	-	25	25	115	85	85	14	10	10	-	-	-	-	-	-
LPS 25/15M	LPS 25/15	300	322	322	-	206	197.5	PG11	PG11	-	25	25	115	85	85	14	10	10	-	-	-	-	-	-
LPS 25/25M	LPS 25/25	300	322	322	-	206	197.5	PG11	PG11	-	25	25	115	85	85	14	10.1	10.1	-	-	-	-	-	-
LPS 32/25M	LPS 32/25	305	341.5	341.5	-	206	197.5	PG11	PG11	-	32	32	140	100	100	18	10.8	10.8	-	-	-	-	-	-
LPS 32/40M *	LPS 32/40 *	305	341.5	341.5	-	206	197.5	PG11	PG11	-	32	32	140	100	100	18	10.8	10.8	-	-	-	-	-	-
LPS 40/25M	LPS 40/25	305	346.5	346.5	-	206	197.5	PG11	PG11	-	40	40	150	105	110	18	11	11	-	-	-	-	-	-
LPS 40/40M *	LPS 40/40 *	305	346.5	346.5	-	206	197.5	PG11	PG11	-	40	40	150	105	110	18	11	11	-	-	-	-	-	-
LPS 40/75M *	LPS 40/75 *	305	346.5	346.5	346.5	206	197.5	PG11	PG11	M16x1.5	40	40	150	105	110	18	13.7	13.7	13.7	-	-	-	-	-
LPS 50/40M *	LPS 50/40 *	310	356.5	356.5	-	206	197.5	PG11	PG11	-	50	50	165	120	125	18	11.6	11.6	-	-	-	-	-	-
LPS 50/75M *	LPS 50/75 *	310	356.5	356.5	356.5	206	197.5	PG11	PG11	M16x1.5	50	50	165	120	125	18	14.4	14.4	14.4	-	-	-	-	-
LPS 50/150M *	LPS 50/150 *	310	387	400	412.5	232	214.5	PG13.5	PG11	M20x1.5	50	50	165	120	125	18	17.7	19.6	20.5	-	-	-	-	-

[1]= Three phase only

[2]= Single phase only

* Models not available in the EU

IN-LINE CENTRIFUGAL ELECTRIC PUMPS

in AISI 304 stainless steel

INSTALLATION LPS

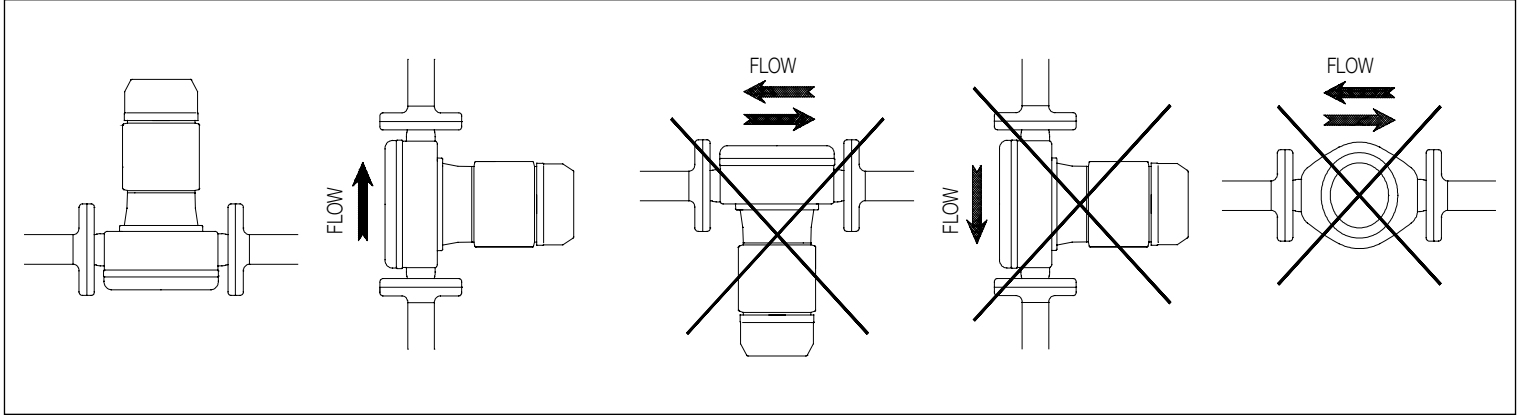

SECTIONAL VIEW LPS

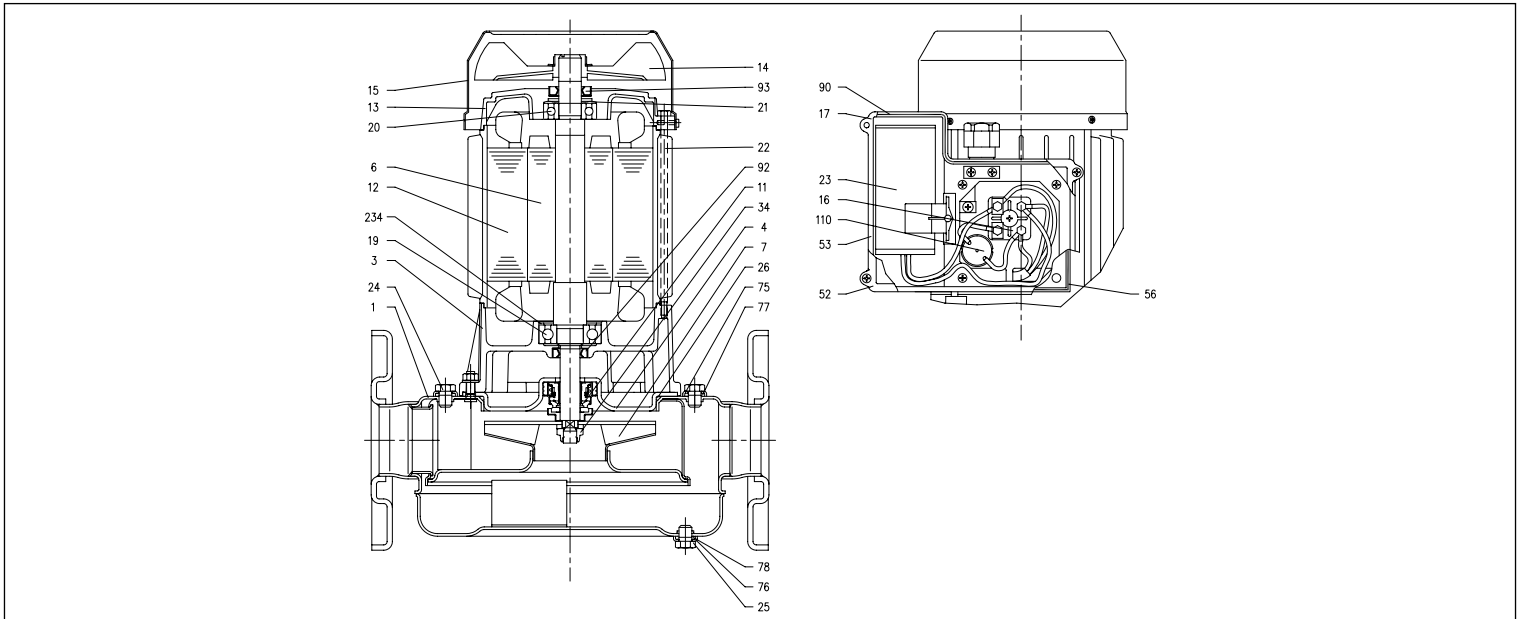

MATERIALS TABLE

Ref.	Name	Material	Ref.	Name	Material
1	Pump body	AISI 304	24	Filler cap	AISI 304
3	Motor mount	Aluminium	25	Drain cap	AISI 304
4	Gasket disk	AISI 304	26	O-ring	NBR
6	Shaft	AISI 303 steel (part in contact with liquid)	34	Impeller nut	AISI 304
7	Impeller	AISI 304	52	Capacitor housing [2]	ABS
11	Mechanical seal	Carbon/Ceramic/NBR	53	Capacitor housing cover [2]	ABS
12	Motor casing	-	56	Terminal block cover gasket	NBR
13	Motor cover	Aluminium	75	Washer	AISI 304
14	Fan	PA	76	Washer	AISI 304
15	Fan cover	Fe P04 galvanised	77	O-ring	NBR
16	Terminal block	-	78	O-ring	NBR
17	Terminal block cover [1]	Aluminium	90	Base enclosure gasket	NBR
19	Pump side bearing	-	92	Seal ring (pump side)	NBR
20	Motor side bearing	-	93	Seal ring (motor side)	NBR
21	Compensator ring	C70 steel	110	Motor protection device [3]	-
22	Linkage	Fe 42 galvanised	234	Circlip	Carbon
23	Condenser [2]	-			

[1]= Three phase only

[2]= Single phase only

[3]= Single phase model LPS 50/150M only

IN-LINE CENTRIFUGAL ELECTRIC PUMPS

in AISI 304 stainless steel

MECHANICAL SEAL LPS

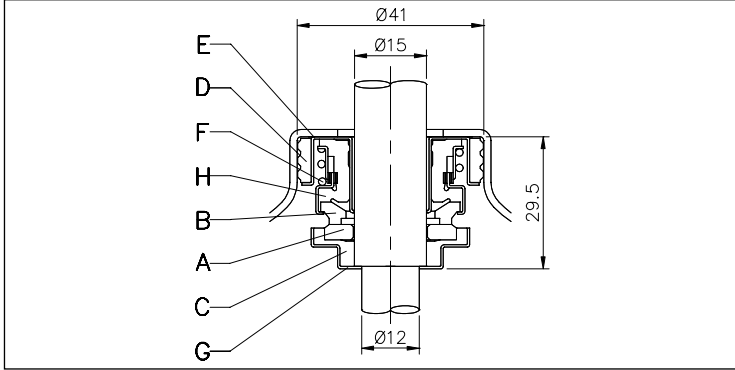

MATERIALS TABLE

Ref.	Name	Material
A	Rotary section	Ceramic
B	Fixed section	Carbon
C	Gasket	NBR
D	Bellows	NBR
E	Ring	AISI 304
F	Spring	AISI 304
G	Structure/frame	AISI 304
H	Circlip	NBR

ELECTRICAL DATA TABLE

Model		P ₂		Efficiency		Capacitor		Efficiency (%)			P ₁		Absorbed current [A]		
Single phase	Three phase	[HP]	[kW]	Single Phase	Three Phase	µF	V _c	Three phase			Single phase [kW]	Three phase [kW]	Three phase		
230V	230/400V							50%	75%	100%			Single phase 230V	230V	400V
LPS 25/08M	LPS 25/08	0.1	0.08	-	-	12.5	450	-	-	-	0.29	0.27	1.51	1.7	1.01
LPS 25/15M	LPS 25/15	0.2	0.15	-	-	12.5	450	-	-	-	0.34	0.33	1.67	1.8	1.03
LPS 25/25M	LPS 25/25	0.33	0.25	-	-	12.5	450	-	-	-	0.45	0.44	2.04	1.9	1.11
LPS 32/25M	LPS 32/25	0.33	0.25	-	-	12.5	450	-	-	-	0.43	0.41	2.0	1.8	1.03
LPS 32/40M*	LPS 32/40*	0.5	0.4	-	-	12.5	450	-	-	-	0.62	0.63	2.74	2.2	1.25
LPS 40/25M	LPS 40/25	0.33	0.25	-	-	12.5	450	-	-	-	0.43	0.42	1.98	1.9	1.09
LPS 40/40M*	LPS 40/40*	0.5	0.4	-	-	12.5	450	-	-	-	0.62	0.63	2.75	2.2	1.25
LPS 40/75M*	LPS 40/75*	1	0.75	-	IE3	25	450	80.9	82.3	82.1	1.07	0.91	4.86	3.0	1.7
LPS 50/40M*	LPS 50/40	0.5	0.4	-	-	12.5	450	-	-	-	0.62	0.61	2.74	2.2	1.25
LPS 50/75M*	LPS 50/75*	1	0.75	-	IE3	25	450	80.9	82.3	82.1	1.08	0.91	4.9	3.0	1.7
LPS 50/150M*	LPS 50/150*	2	1.5	-	IE3	40	450	82.7	86.1	87.0	1.82	1.72	8.07	6.6	3.8

* Models not available in the EU

NOISE DATA TABLE

Model		P ₂		L _{pa} - dB(A)*
Single phase	Three phase	[HP]	[kW]	
230V	230/400V			
LPS 25/08M	LPS 25/08	0.1	0.08	60
LPS 25/15M	LPS 25/15	0.2	0.15	
LPS 25/25M	LPS 25/25	0.33	0.25	
LPS 32/25M	LPS 32/25	0.33	0.25	61
LPS 32/40M	LPS 32/40	0.5	0.4	
LPS 40/25M	LPS 40/25	0.33	0.25	61
LPS 40/40M	LPS 40/40	0.5	0.4	
LPS 40/75M	LPS 40/75	1	0.75	62
LPS 50/40M	LPS 50/40	0.5	0.4	62
LPS 50/75M	LPS 50/75	1	0.75	63
LPS 50/150M	LPS 50/150	2	1.5	65

* Mean noise level measured at 1 m from the electric pump.
Tolerance ± 2.5 dB.